

UDTT-65/80 DYNAMIC TUMBLE DRYERS



TOUCH II

User friendly and totally programmable
Touch II
USB Connection. PC software free of charge for
programming, traceability, data analysis...
Videos on display (ads, instructions, etc.)
37 languages



OUTSTANDING FEATURES

Reversing drum action as standard
Stainless steel drum as standard
Frequency inverter as standard



EFFICIENCY

DUAL AIRFLOW - mixed axial-radial airflow
Extra Large Stainless Steel Lint Filter



VERSATILITY

Make to order - customization
WET CLEANING
OPL > Multivending - Standard OPL model easily
transformable to coin laundry and viceversa



CONNECTIVITY

Remote technical service
Management of laundries: OPL and COIN
Remote payment



ERGONOMICS

Accessible Lint Drawer filter, made of stainless steel
Largest door diameters
Opening sense of door adjustable on site



MAINTENANCE

Hinged Front Panel: easy and ergonomic access
Technical menu: statistics, alarm, autotest, data
recovery for technicians and maintenance with M
console

OTHERS

Grey skinplate outer casing, stainless steel look
Transmission by direct drive
SOFT DRY - new drum with stamped holes
COOL DOWN - anti-wrinkle at the end of the cycle
Heating options: electric, gas and steam
CE and ETL approved



OPTIONS

- EFFICIENT DRY - Intelligent humidity control with new drum inlet temperature control
- Double pane door glass
- Reverse door opening
- SFEX - Integrated Fire Extinguishing System
- New dosing/vaporizing system
- Printer
- DomusConnect communication kit
- Stainless steel AISI 304 outer casing
- Stainless steel AISI 304 front panel
- Stainless steam battery
- Low pressure steam battery
- Wooden packing
- Exhaust silencer Ø 8"
- Rear panel external air + filter
- Ship voltage for electric models: 440V III 50/60 Hz No neutral

TECHNICAL DATA		UNIT.	UDTT - 65		UDTT - 80	
CAPACITY						
Capacity 1/18		lb	70		80	
Capacity 1/20		lb	60		75	
Hourly Output *		lb/h	59,3		138 / 9	
Evaporation capacity *		l/h	30,9		32,1	
DRUM						
Ø Drum		in	37.25		37.25	
Ø Door		in	31.50		31.50	
Door center height		in	41		41	
Load hole bottom height		in	64.50		64.50	
Drum length		in	30.75		36.85	
Drum volume		CðFt	19		23	
POWER						
Drum motor power		HP	0,75		0,75	
Fan motor power		HP	0,75		0,75	
Electric heating power		Kw	30		36	
Total electric power (elec.model)		Kw	31,15		37,15	
Gas heating power		BTU	139898		139898	
Total electric power (gas model)		Kw	1,15		1,15	
Steam heating power		kw	50,1		50,1	
Steam heating power (gas model)		kw	1,15		1,15	
CONNECTIONS			ELECTRICAL	STEAM / GAS	ELECTRICAL	STEAM / GAS
Tension 120 V - I + N + T	Nº x mm2 / A	-	-	3 x 1,5 / 20A	-	3 x 1,5 / 20A
Tension 230V - III + T	Nº x mm2 / A	4 x 35 / 100A	4 x 35 / 100A	3 x 1,5 / 20A	4 x 50 / 125A	3 x 1,5 / 20A
Tension 400V - III + N + T	Nº x mm2 / A	5 x 16 / 63A	5 x 16 / 63A	3 x 1,5 / 20A	5 x 16 / 63A	3 x 1,5 / 20A
Ø Gas inlet	BSP		1/2"		1/2"	
Ø Steam inlet	BSP		1"		1"	
Ø Condensed (Steam models)	BSP		1"		1"	
DIMENSIONS / PACKING DIMENSIONS						
Net Width / Gross Width		in	38.75 / 42		38.75 / 42	
Net Depth / Gross Depth		in	41.50 / 45.50		47.60 / 51.60	
Net Height / Gross Height		in	76.60 / 82		76.60 / 82	
Height without heating battery		in	-		-	
Net weight / Gross weight		lb	507 / 573		573 / 628	
OTHERS						
Max airflow		CFM	706		706	
Ø Duct Size		in	8		8	
Sound level		dB	65		65	

* It may vary depending on the type of heating, filter cleanliness or extraction type.

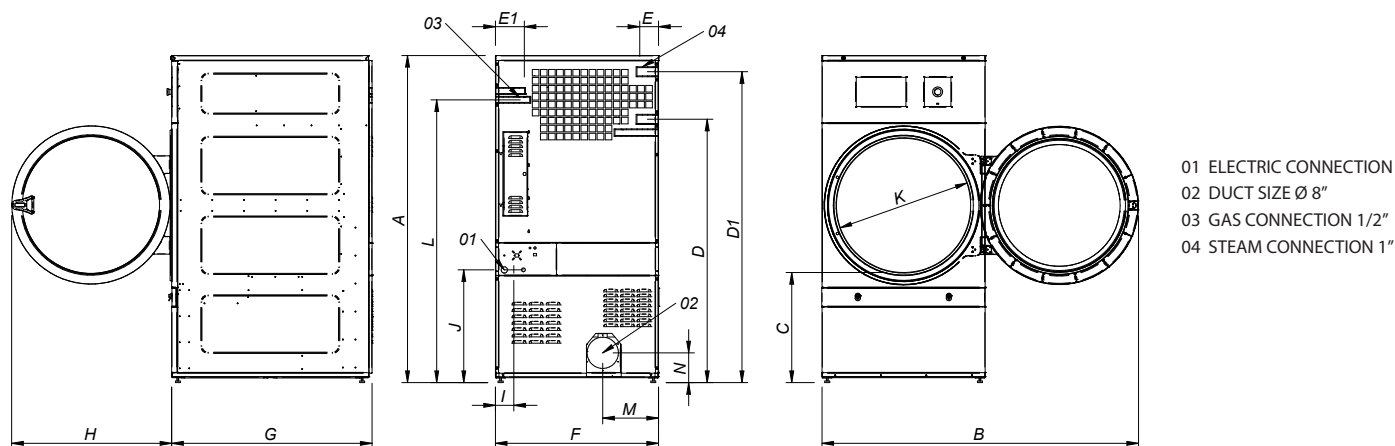

	A	B	C	D	D1	E	E1	F	G	H	I	J	K	L	M	N
UDTT-65	76.60	75	25	62.60	74	4.50	6.85	38.75	41.50	37.75	4.30	26.75	31.60	67.25	13.35	7
UDTT-80	76.60	75	25	62.60	74	4.50	6.85	38.75	47.60	37.75	4.30	26.75	31.60	67.25	13.35	7